

ELEVATION OF FOLDING DOORS.

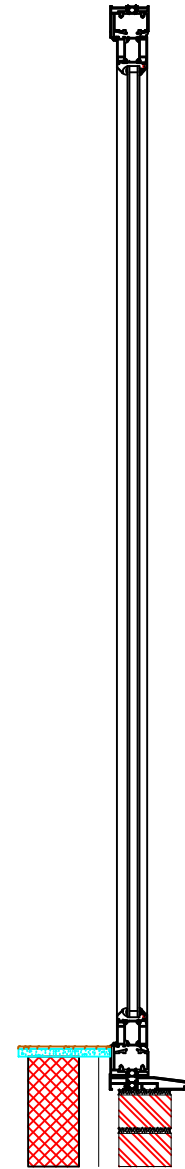

SECTION OF FOLDING DOORS.

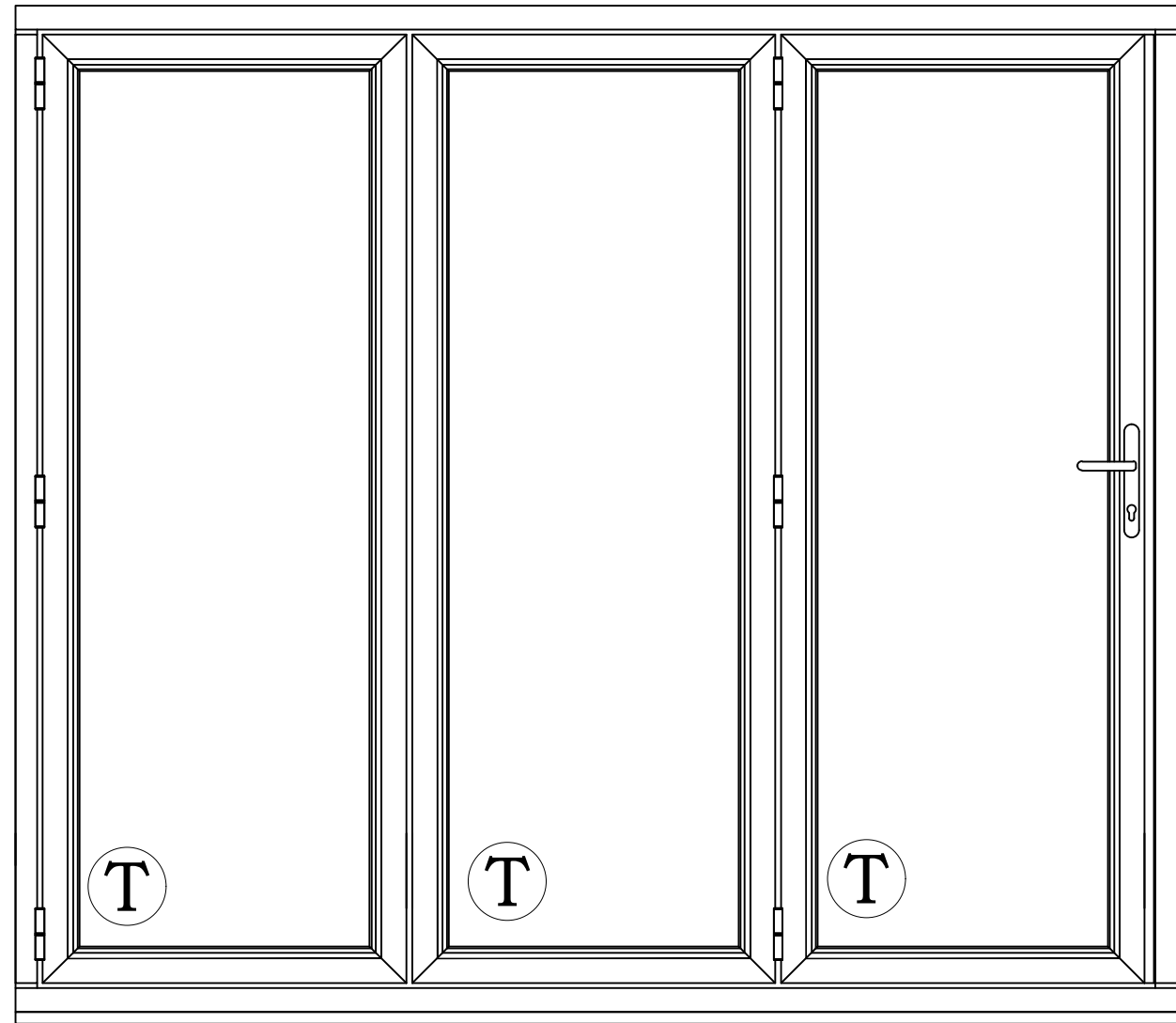
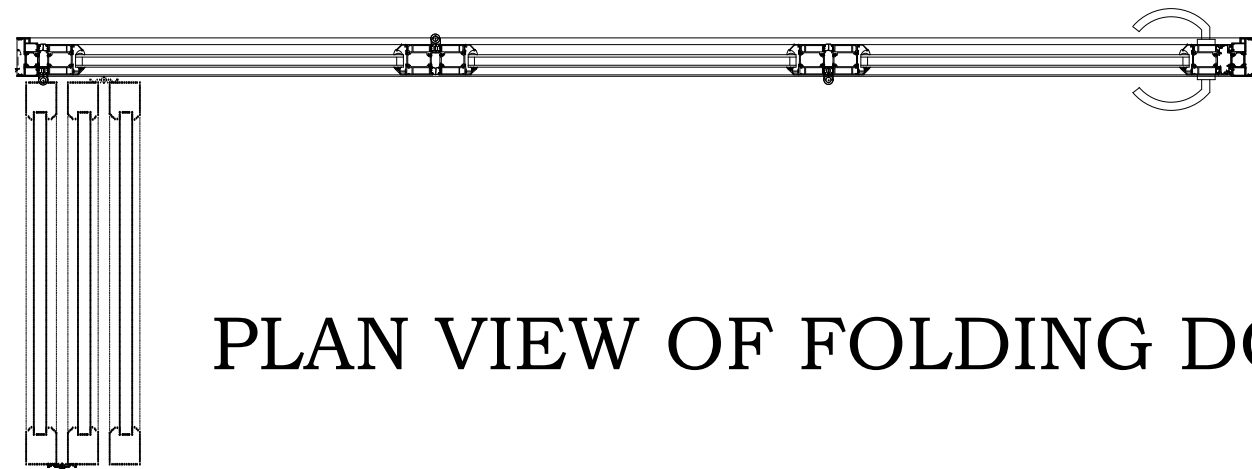

PLAN VIEW OF FOLDING DOORS.

PRODUCT SPECIFICATION	
●EXTERIOR:	FJ PINE/CLAD(COLOUR TBC)
●INTERIOR:	FJ PINE PAINTED(COLOUR TBC)
●WINDOW HARDWARE:	TBC
●DOOR HARDWARE:	TBC
●GLAZING:	LOW E II WITH ARGON ①-Tempered ②-Obscure ③-Triple glazed
●GLAZING DESIGN:	22m GLAZING BAR WITH SPACER SILVER/WHITE/BRONZE BAR AS SHOWN
●WINDOW/DOOR HANDLING	
Elevation-	
Outswing-	
Inswing-	

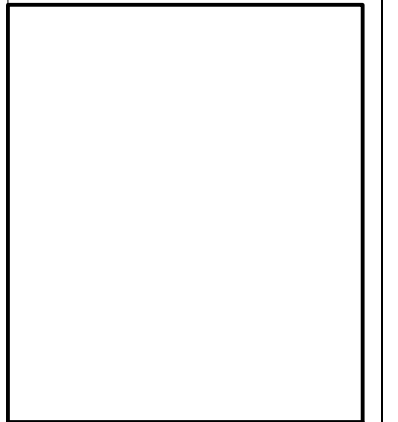

ALL UNITS SHOWN ARE VIEWED FROM THE EXTERIOR

DO NOT SCALE FROM THIS DRAWING.
 USE FIGURED DIMENSIONS ONLY.
 THIS SCHEDULE TO BE READ IN CONJUNCTION WITH
 .
 .
 THIS DRAWING IS COPYRIGHT AND MAY ONLY BE REPRODUCED WITH SIGNATURE WINDOWS PERMISSION.

Signature
 WINDOWS & DOORS

Stephen St. Dunlavin
 Co-Wicklow.
 Tel: 045 401000
 Fax: 045 401001
 E-Mail: sales@signaturewindows.ie

CLIENT: ALU CLAD BI-FOLD DOOR
 SITE ADDRESS: STEPHEN STREET
 DUNLAVIN
 CO. WICKLOW

DATE: 01/03/2016 SCALE: N/A
 DRAWING NO. 1 DRAWN BY T.H

I agree with the above quantities, unit types, sizes, design and openings
 SIGNED: _____ DATE: _____

NOTE: All dimensions shown above are block opening dimensions.
 Suitable fitting tolerances are included in sizes shown